

**ARCHITECTURAL SITE  
GENERAL NOTES**

1. ARCHITECTURAL SITE PLAN IS ISSUED FOR REFERENCE ONLY.
2. NOT USED.
3. RE ELECTRICAL DRAWINGS FOR SITE INFORMATION INCLUDING, BUT NOT LIMITED TO THE FOLLOWING:
  - SITE LIGHT STANDARD LOCATIONS AND SIZES
  - ELECTRICAL SLEEVING LOCATIONS AND SIZES
  - TELEPHONE AND CABLE T.V. PULL BOX LOCATIONS
  - ELECTRICAL MANHOLE LOCATIONS AND DETAILS
  - PULL BOX LOCATIONS AND SIZES FOR VARIOUS SITE LIGHTING ELEMENTS
  - EXTERIOR BUILDING ILLUMINATION AND UTILITY COORDINATION
4. REFERENCE SPECIFICATIONS FOR SITE SIGNAGE PACKAGE INFORMATION.
5. REFERENCE LANDSCAPE DRAWINGS FOR:
  - LANDSCAPE PLANTING AND DETAILS
  - SOODING AND SEEDING
  - LANDSCAPE BED DRAINAGE
  - HARDSCAPE LAYOUT AND DETAILS (SPECIALTY PAVING)
6. REFERENCE IRRIGATION IN LANDSCAPE DRAWINGS FOR:
  - HEAD AND VALVE LOCATIONS AND SIZES
  - IRRIGATION SLEEVING LOCATIONS AND SIZES
  - IRRIGATION SYSTEM CONTROLLER LOCATION
  - DETAILS AND SPECIFICATIONS

**ARCHITECTURAL SITE PLAN  
LEGEND**

- NEW CONCRETE SIDEWALK OR PAVING
- EXISTING TO REMAIN
- NEW ADDITION FOOTPRINT
- NEW ASPHALT PAVING
- EXISTING BUILDING FOOTPRINT TO REMAIN
- FLATWORK TO BE DEMOLISHED
- PROPERTY LINE
- EASEMENT, BUILDING SETBACK & R.O.W.
- CHAIN LINK FENCE
- EXISTING CHAIN LINK FENCE
- NEW PARKING SPACE COUNT
- EXISTING PARKING SPACE COUNT
- FIRE LANE (EXISTING)
- REQUIRED ACCESSIBLE PATH
- EXISTING TO REMAIN TREE  
REF. LANDSCAPE

**ARCHITECTURAL SITE PLAN  
NOTES BY NUMBER**

- 1 DEMO EXISTING MEDIANS AND PATCH AND REPAIR PAVING. REF. CIVIL
- 2 EXISTING PARKING LOT TO REMAIN AS IS
- 3 ALT. #5- NEW RAMMED EARTH WALL. REF. 1/A-051
- 4 ALT. #6- NEW BATTEN SEAM METAL ROOF. REF ENLARGED PLANS AND ELEVATIONS
- 5 EXISTING CHAIN LINK FENCE AND GATES TO REMAIN (BASE BID) TUBULAR STEEL FENCE & AUTO. GATE (ADD ALT. #4)
- 6 DEMOLISH EXISTING BUILDING CONNECTOR. NEW ENTRY VESTIBULE TO BE CONSTRUCTED. REF. PLANS, DEMOLITION PLANS, AND ELEVATIONS
- 7 DEMOLISH EXISTING ENTRY VESTIBULE AND WALL ABOVE. CONSTRUCT NEW CURTAIN WALL. REF. PLANS, ELEVATIONS AND DEMOLITION PLANS
- 8 NEW PARKING LOT STRIPING. NIC
- 9 NEW FENCE. REF. LANDSCAPE
- 10 NEW TREES. OFCI. REF. LANDSCAPE
- 11 CANTILEVERED CAR SHELTERS. ADD ALTERNATE #1.
- 12 STAFF ENTRY ONLY SIGNAGE. REF. 4/A-051A
- 13 DUMPSTER & SCREENING TO BE LOCATED UNDER EXISTING CANOPY. REF. LANDSCAPE
- 14 EXISTING CHILLER TO REMAIN. REF. MEP
- 15 AC-1. REF. MEP
- 16 EXISTING FLAGPOLE AND CONCRETE PAD TO REMAIN
- 17 OVERHEAD TRANSFORMER TO REMAIN
- 18 METERS. REF. MEP
- 19 CONTAINER. OFCI
- 20 EXISTING FIRE HYDRANT. REF. CIVIL
- 21 FIRE DEPARTMENT LOCK BOX. COORD. FINAL LOCATION W/ ARCH AND AHJ

**NEW SCOPE OF WORK  
NOTES BY NUMBER**

- A GC TO PRIME EXISTING STEELSTRUCTURES WITH SHERWIN WILLIAMS KEM KROMIK UNIVERSAL METAL PRIMER AND PAINT WITH SHERWIN WILLIAMS HI-SOLIDS POLYURETHANE. INSTALL PER MANUFACTURER'S RECOMMENDATION**
- B REFER TO CIVIL DRAWINGS DATED 3/30/21 FOR NEW SCOPE OF WORK.**

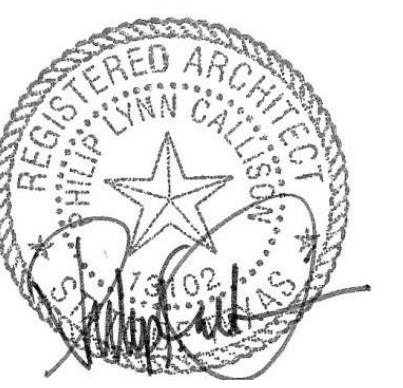

08/25/16

**Revisions**

NO	ISSUE	DATE
<b>Sheet Information</b>		
Date	May 25, 2016	
Job Number	146054.000	
Drawn	VBW	
Checked	PLC	
Approved	PLC	

Title

**ARCHITECTURAL  
SITE PLAN**

Sheet

**A-050**

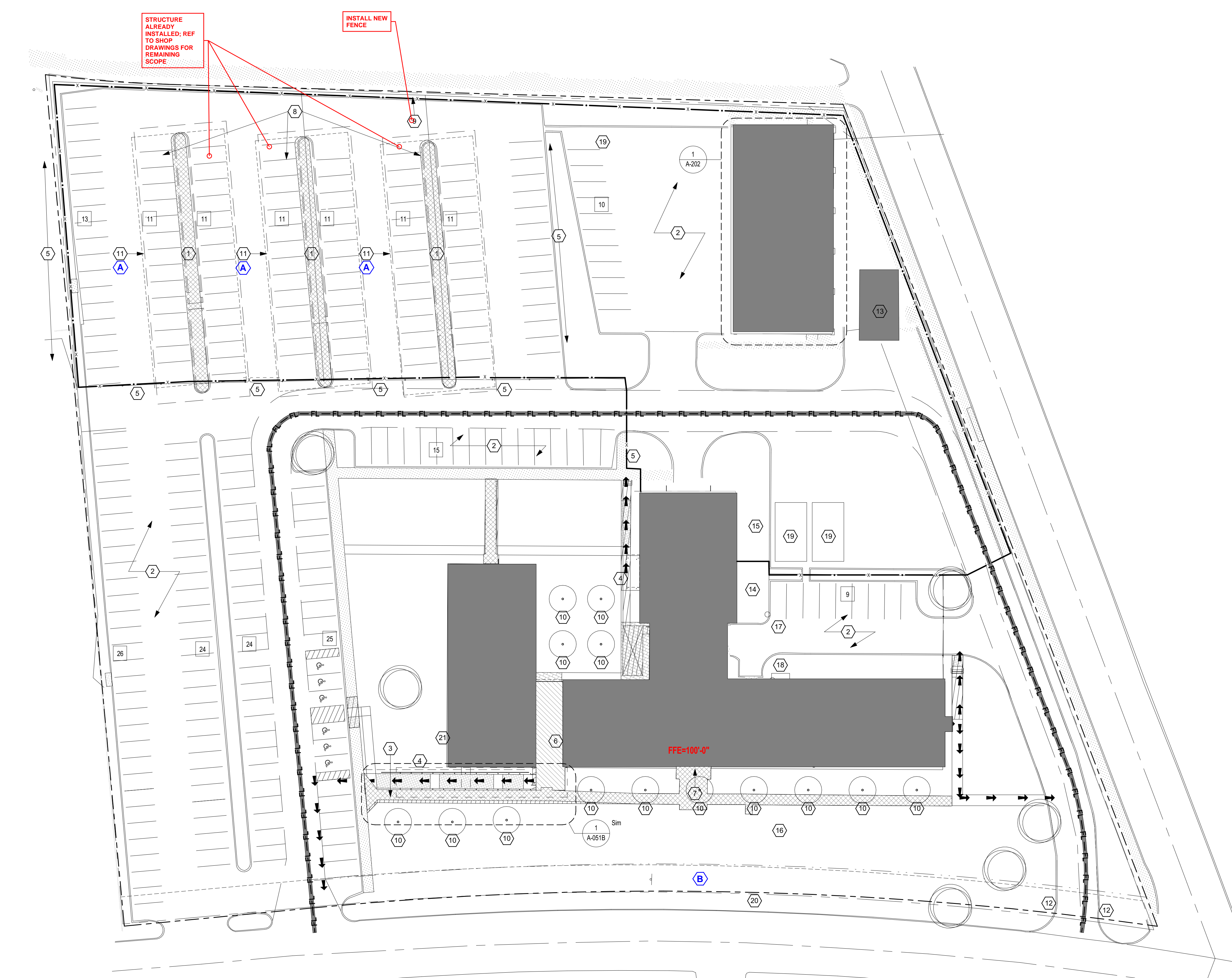

**1 SITE PLAN**  
1" = 30'-0"